

PLUS5

MECHANICAL ZERO POINT SYSTEM

0.1



Pag. 0.1.4

PLUS 5 - 52

Plus 5 - Sistema Zero Point meccanico



Pag. 0.1.5

PLUS 5 - 96

Plus 5 - Sistema Zero Point meccanico

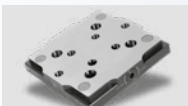

Pag. 0.1.6

PLUS 5 ALL IN ONE 52/96

Plus 5 All in One
Sistema Zero Point meccanico



Pag. 0.1.7

PLUS 5 INDEX - 52

Plus 5 Index - Sistema Zero Point meccanico



Pag. 0.1.8

PLUS 5 INDEX - 96

Plus 5 Index - Sistema Zero Point meccanico



Pag. 0.1.9

PLUS 5 INDEX ALL IN ONE 52/96

Plus 5 All in One
Sistema Zero Point meccanico

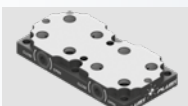

Pag. 0.1.10

PLUS 5 - 52

PLUS 5 - 96

Piastre serraggio



Pag. 0.1.14

PLUS 5 - 52

Interfaccia 96



Pag. 0.1.15

PLUS 5 - 52/96

Piastre di riduzione



Pag. 0.1.16

PLUS 5 - 52/96

Perni di bloccaggio

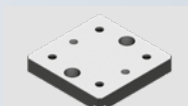

Pag. 0.1.18

PLUS 5 - 52/96

Piastre di interfaccia pallets

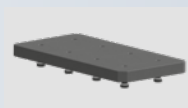

Pag. 0.1.19

PLUS 5 - 52/96

Piastre

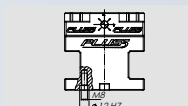

Pag. 0.1.20

PLUS 5 - 52/96

Rialzi



Pag. 0.1.21

PLUS 5 - 52/96

Piramidi alluminio



Pag. 0.1.22

PLUS 5 - 52

PLUS 5 - 96

Basculle



Pag. 0.1.24

PLUS 5 - 96

Bascula multipla

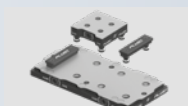

Pag. 0.1.25

PLUS 5 - 52/96

- Piastrina di sicurezza
- Piastra allineamento

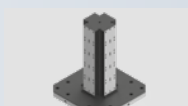

Pag. 0.1.26

PLUS 5 - 52

Cubi

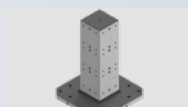

Pag. 0.1.27

PLUS 5 - 96

Cubi



Pag. 0.1.28

PLUS 5 - 52/96

Accessori

PLUS5

MECHANICAL ZERO POINT SYSTEM

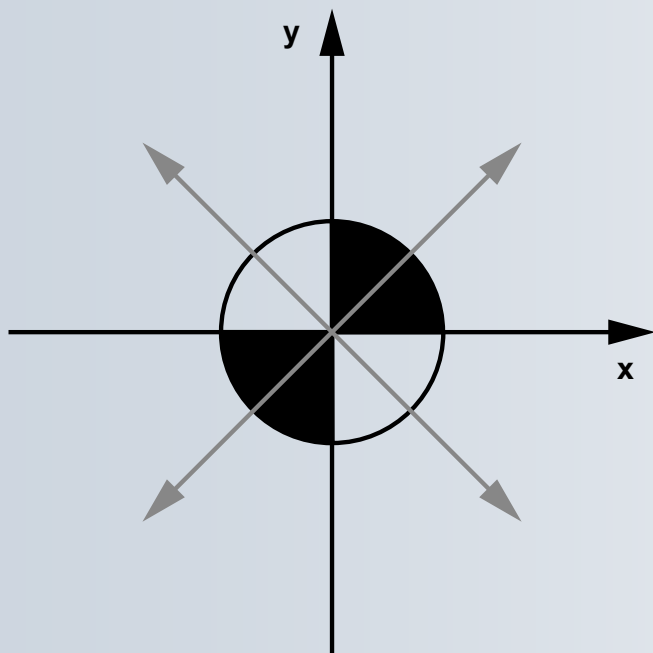
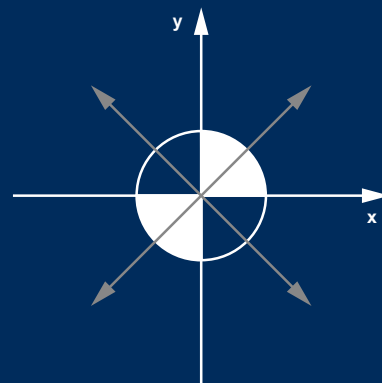

PLUS5

- Il simbolo qui a lato rappresenta il sistema di trasmissione vettoriale delle forze che agisce vincolando i perni in modo uniforme e in tutte le direzioni.



Guarda il video



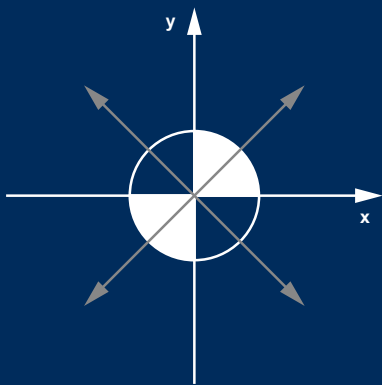

PLUS5

MECHANICAL ZERO POINT SYSTEM

0.1

PLUS5 BENEFITS

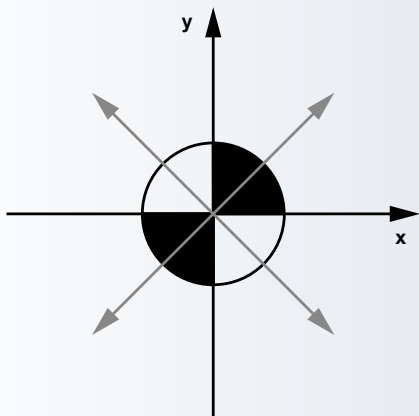

- ▶ Sistema di bloccaggio sbloccaggio dei perni con una rotazione di soli 180 gradi
- ▶ Non necessita di chiave dinamometrica. Il fine corsa determina il bloccaggio/sbloccaggio
- ▶ Ripetibilità < 0.005mm
- ▶ Pull down force 7 kN per Plus 5 52 e 8 kN per Plus 5 96
- ▶ Forza di tenuta 40 kN per Plus 5 52 e 80 kN per Plus 5 96

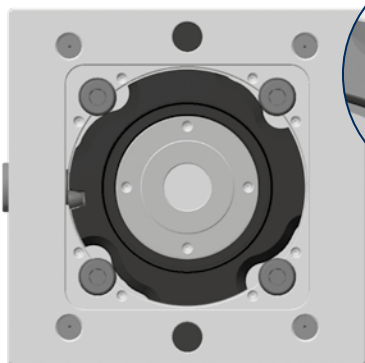

Aperto

Il meccanismo progettato per bloccare i perni è costituito da una camma azionata da un perno eccentrico.

Il sistema garantisce elevate prestazioni in termini di precisione e forza di bloccaggio. Ciò è dovuto in particolare al fatto che la camma blocca contemporaneamente i 4 perni verso l'esterno.

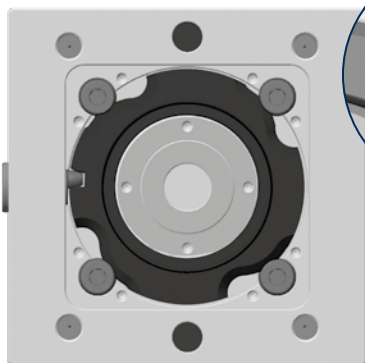

Chiuso

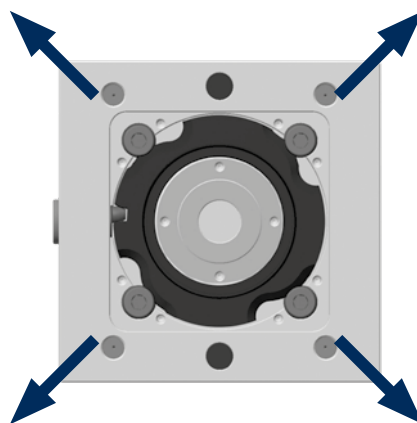



- Completo di chiave 10mm
- Perni non inclusi

SEZIONE A-A

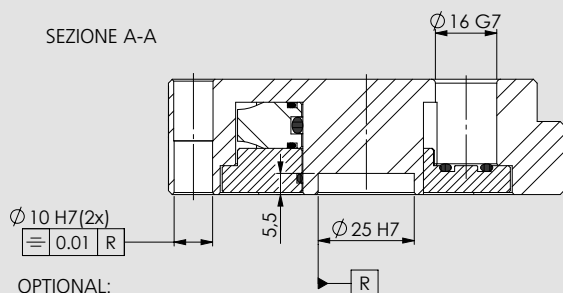

OPTIONAL:
Chiavetta di posizionamento multislot
58341393 / 58341395

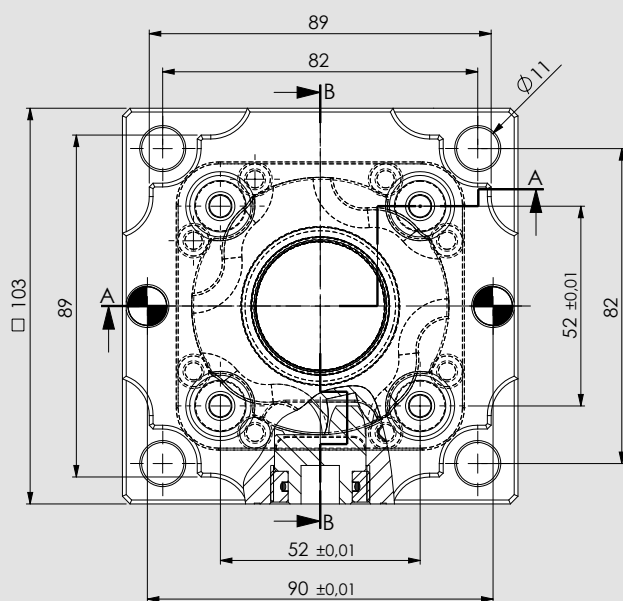
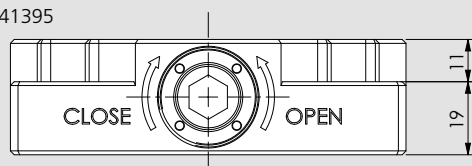

SEZIONE B-B

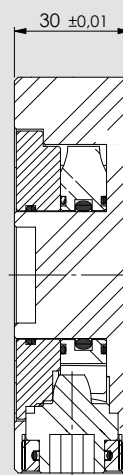

Soggetto a modifiche tecniche

Cod.	Peso (Kg)
46240101	2



- Completo di chiave 10mm
- Perni non inclusi

SEZIONE A-A

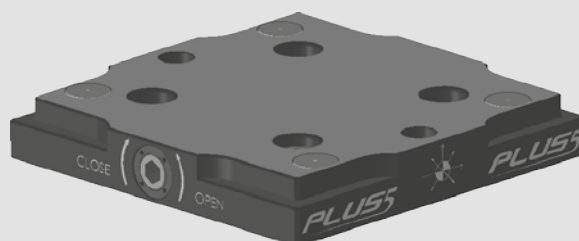
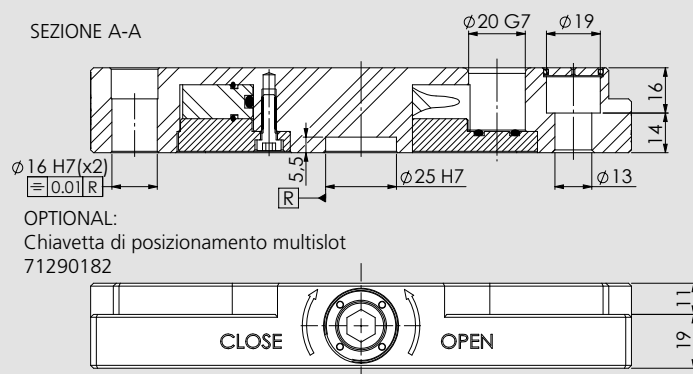

SEZIONE B-B

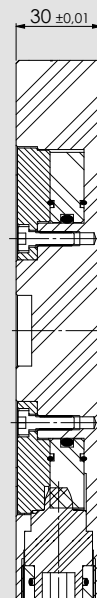

Soggetto a modifiche tecniche

Cod.	Peso (Kg)
46240102	7,5

PLUS 5 All in One 52/96

PLUS 5 All in One - Sistema Zero Point meccanico



- Completo di:
 - chiave 10mm
 - tappi di protezione (Plus 5 52 / 96)
- Perni non inclusi

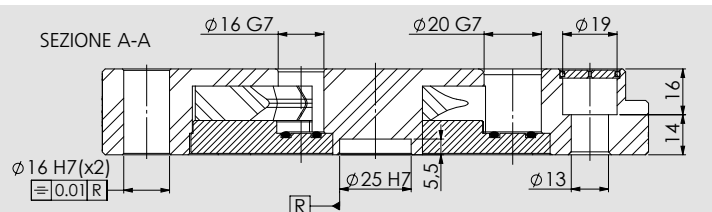

OPTIONAL:
Chiavetta di posizionamento multislot
71290182

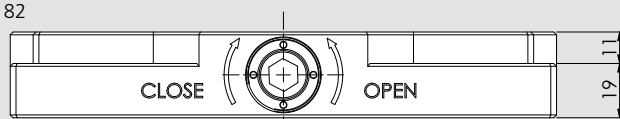

SEZIONE B-B

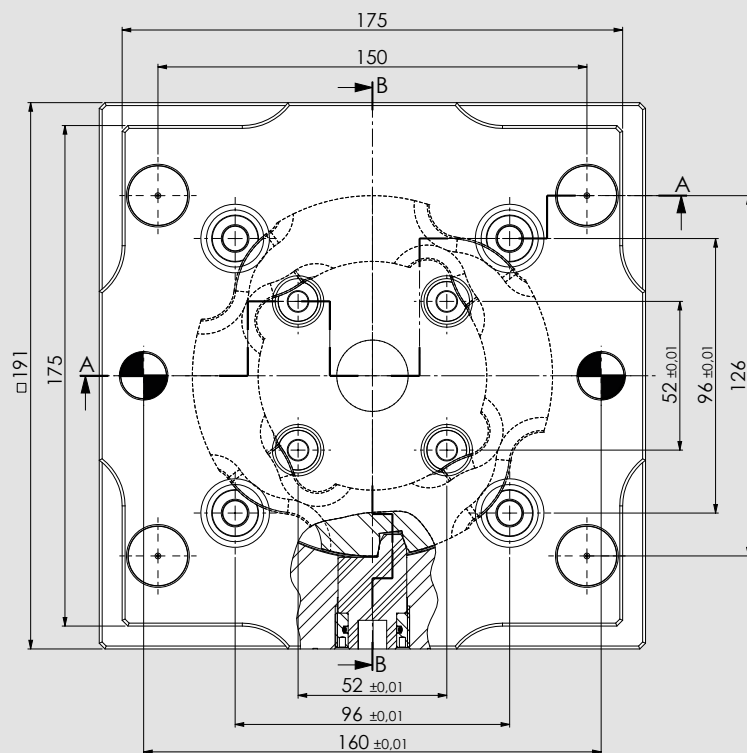
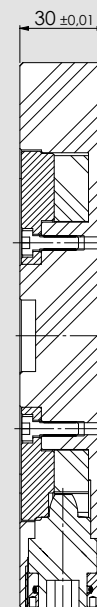

Soggetto a modifiche tecniche

Cod.	Peso (Kg)
46240103	7,5



- Completo di chiave 10mm
- Perni non inclusi

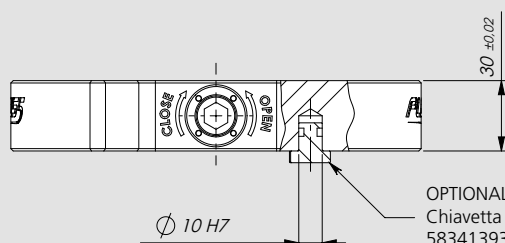

OPTIONAL:
Chiavetta di posizionamento multislot
58341393 / 58341395

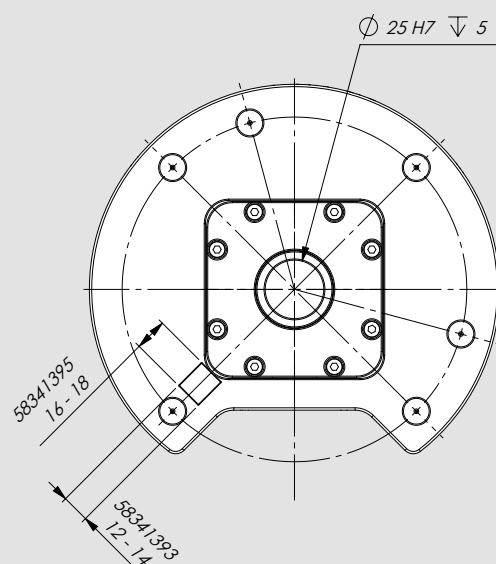
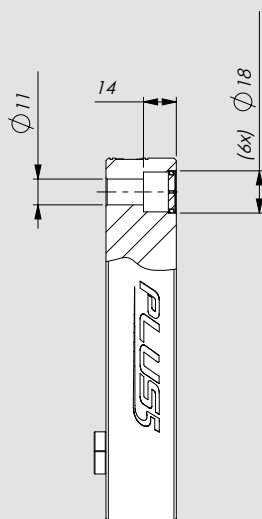
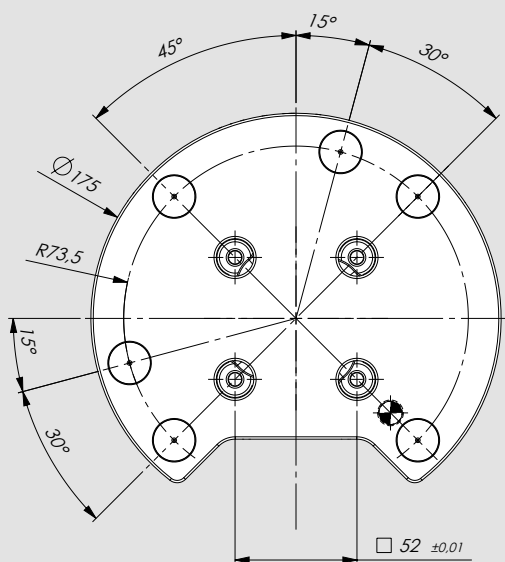

Soggetto a modifiche tecniche

Cod.	Peso (Kg)
46240111	6

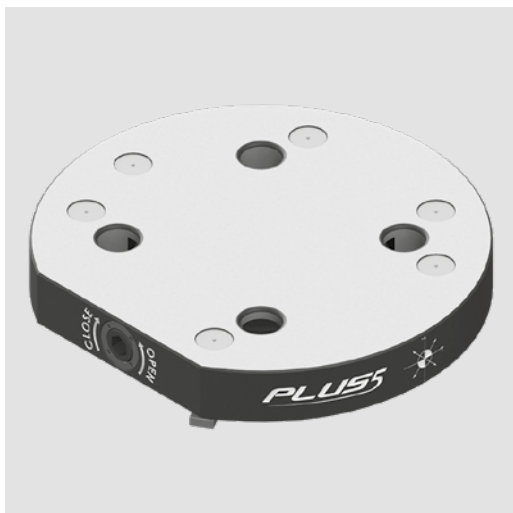

- Completo di chiave 10mm
- Perni non inclusi

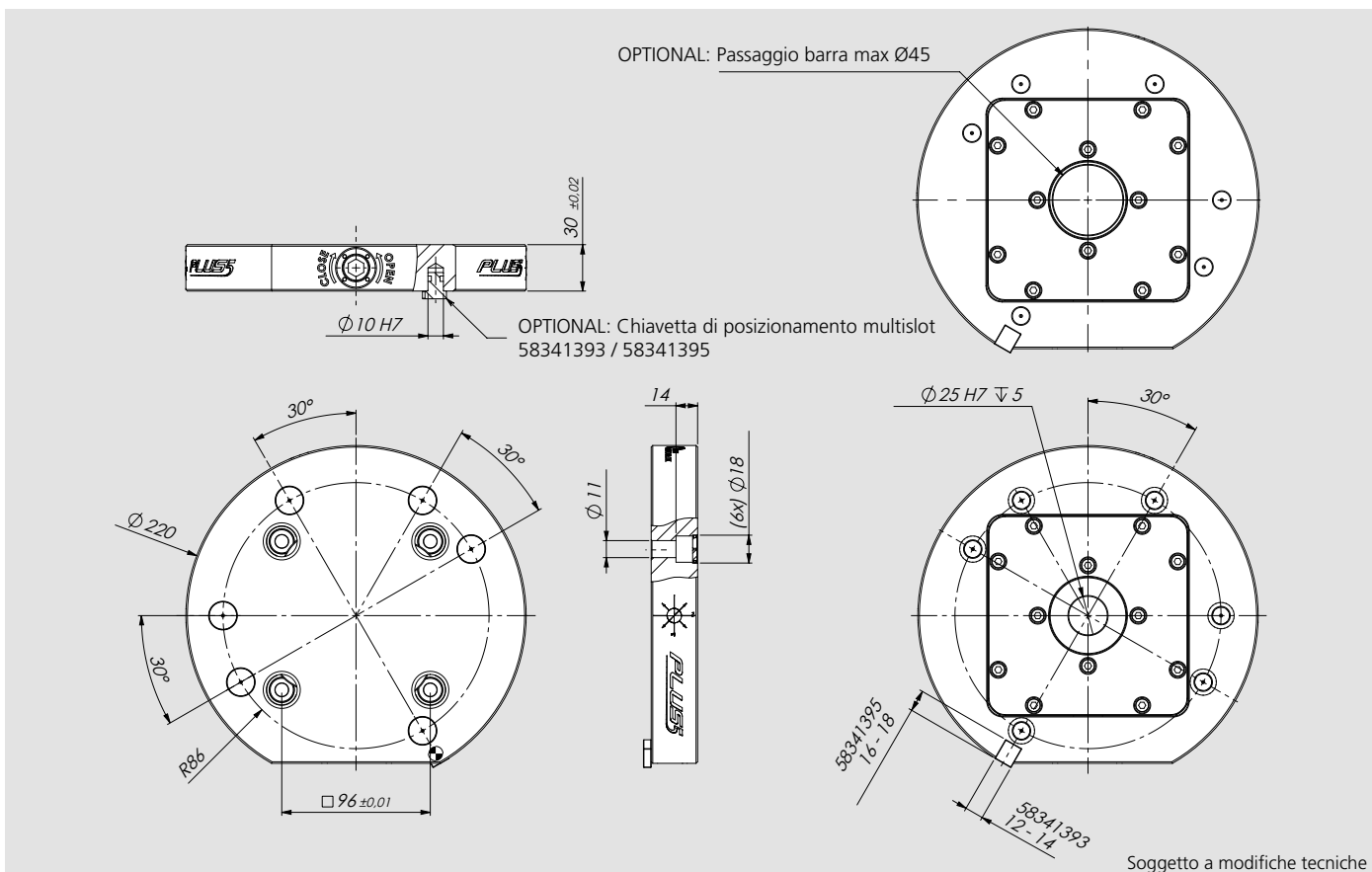

Cod.	Peso (Kg)
46240112	8

Esempio di impiego

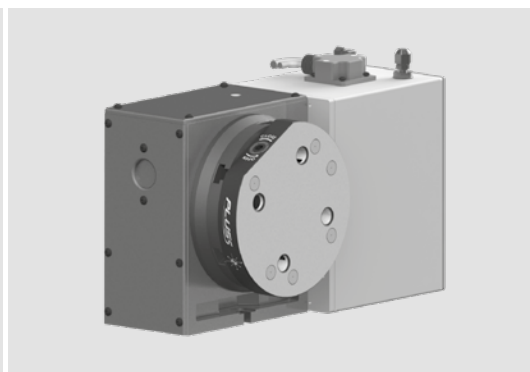
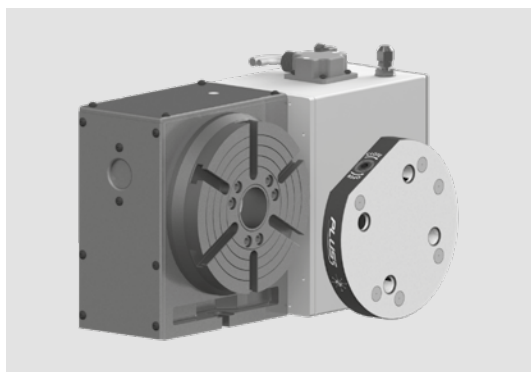



- Completo di:
 - chiave 10mm
 - tappi di protezione (Plus 5 - 96)
- Perni non inclusi

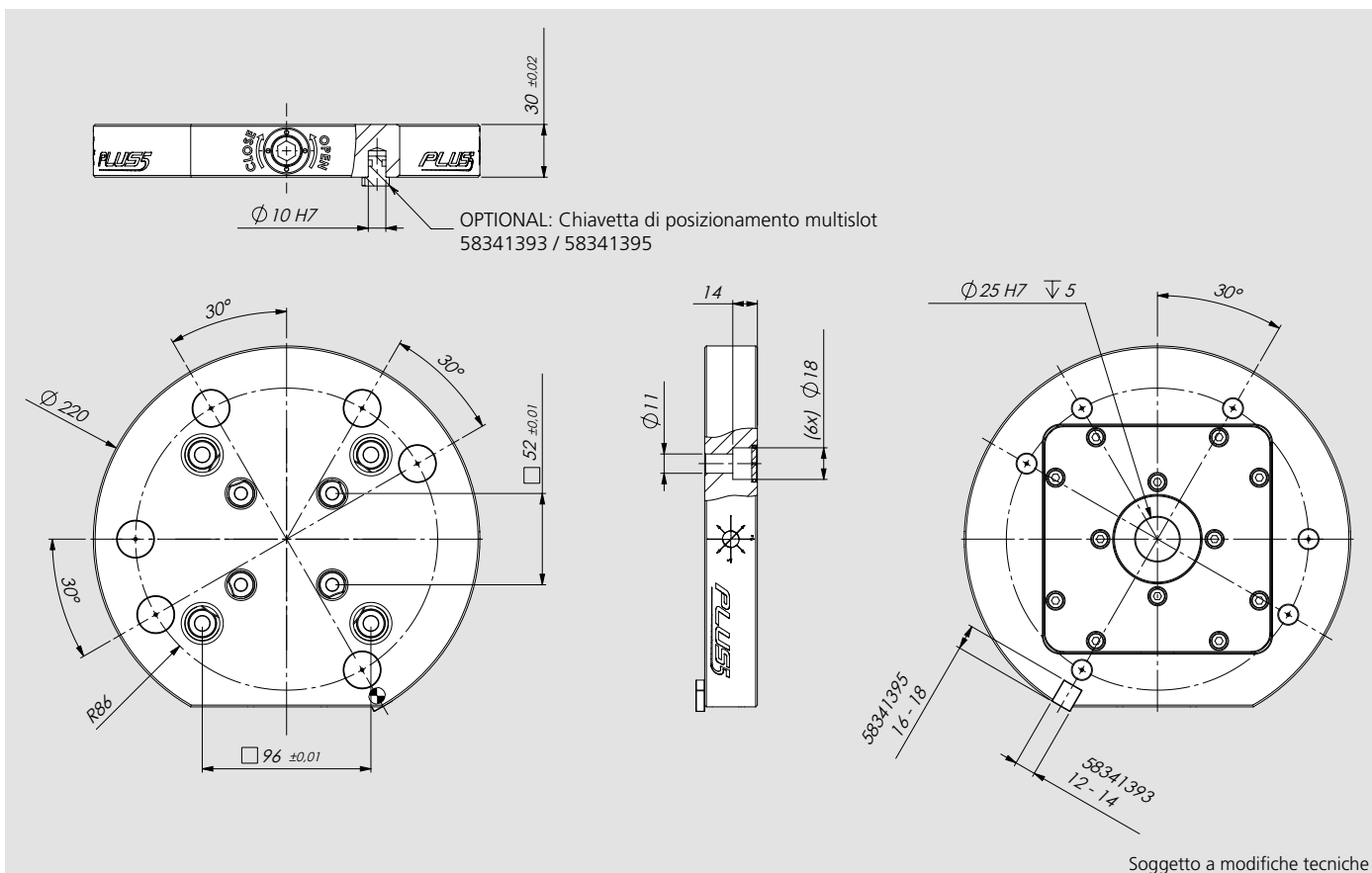

Cod.	Peso (Kg)
46240113	8



- Completo di:
 - chiave 10mm
 - n. 2 piastrine di sicurezza (cod. 46248205)
- Perni non inclusi

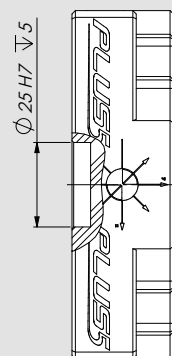
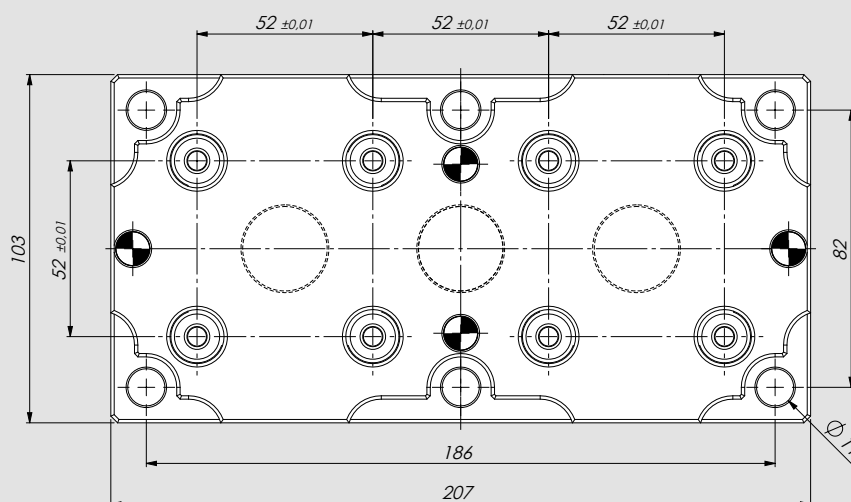
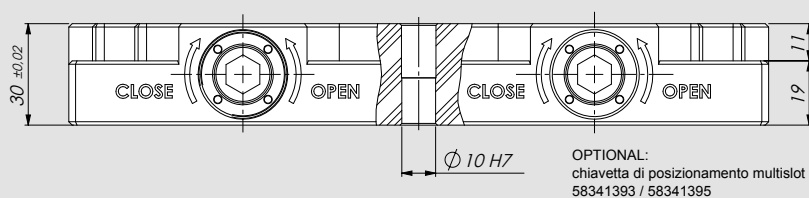

Soggetto a modifiche tecniche

Cod.	Peso (Kg)
46248200	4

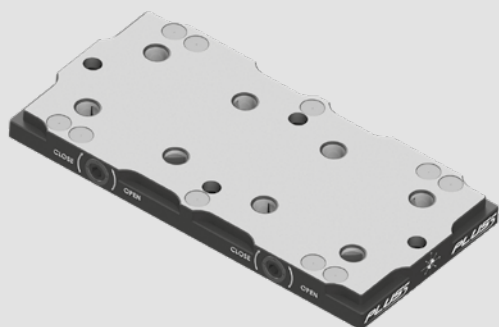

- Completo di:
 - chiave 10mm
 - n. 2 piastrelle di sicurezza (cod. 46248215)
- Perni non inclusi

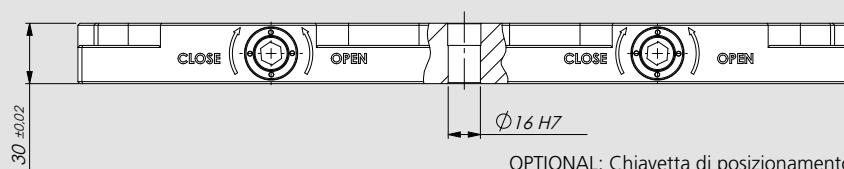

OPTIONAL: Chiavetta di posizionamento multislot 71290182

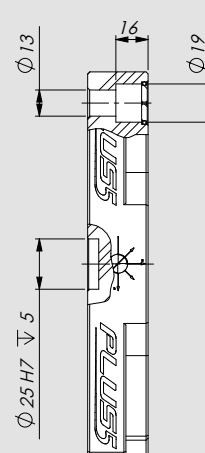
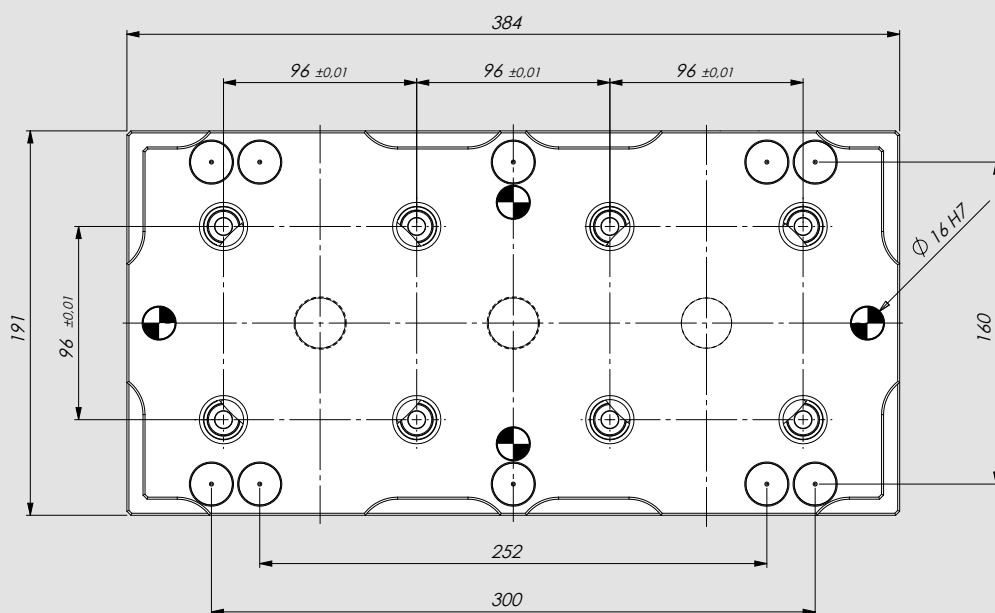

Soggetto a modifiche tecniche

Cod.	Peso (Kg)
46248210	16

Esempio di impiego

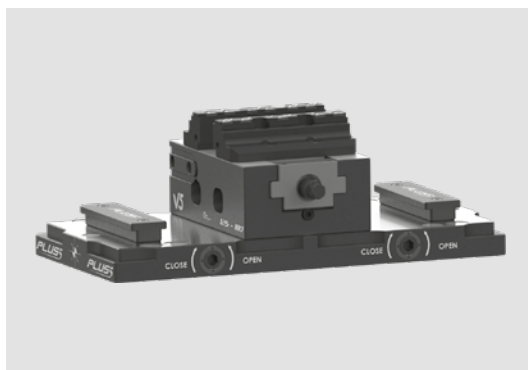

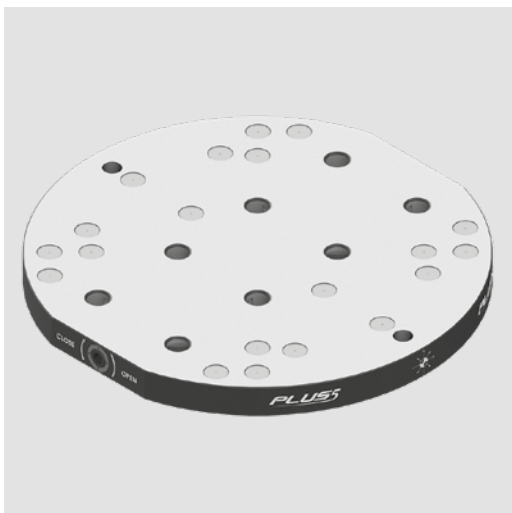

- Completo di:
 - chiave 10mm
 - n. 2 piastrine di sicurezza (cod. 46248215)
- Perni non inclusi

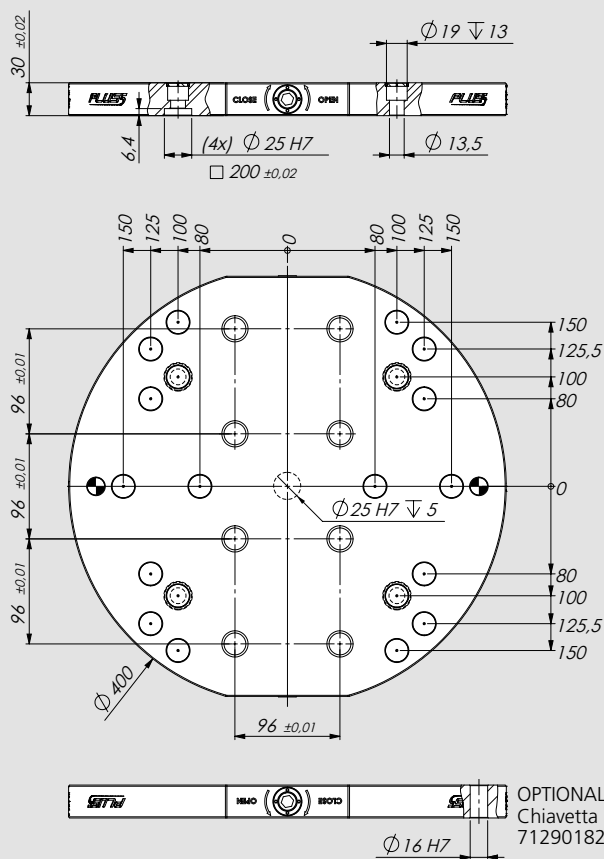

Soggetto a modifiche tecniche

OPTIONAL:
Chiavetta di posizionamento multislot
71290182

Cod.	Peso (Kg)
46248220	27

Esempio di impiego

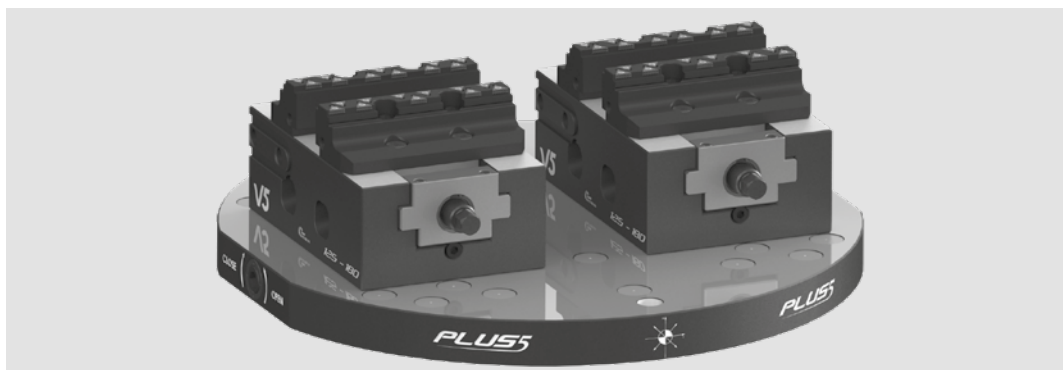



- Completo di:
 - chiave 10mm
 - n. 2 piastrine di sicurezza (cod. 46248215)
- Perni non inclusi
- n. 4 innesti maschio

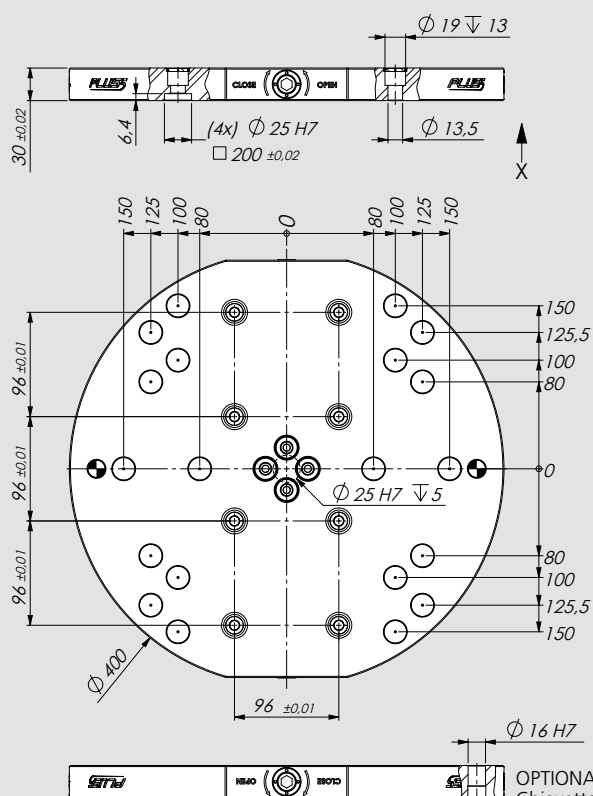

OPTIONAL:
Chiavetta di posizionamento multislot
71290182

VISTA da X

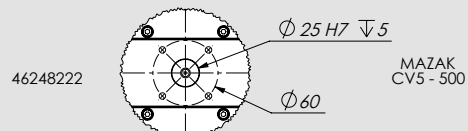

MAZAK
CV5 - 500

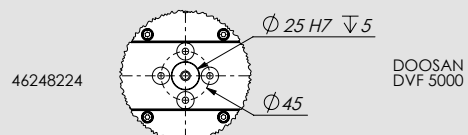

DOOSAN
DVF 5000

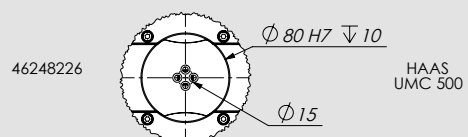

HAAS
UMC 500

Soggetto a modifiche tecniche

Descrizione	Cod.	Descrizione	Cod.	Descrizione	Cod.	Peso (Kg)
Mazak CV5-500	46248222	Doosan DVF 5000	46248224	Haas UMC 500	46248226	27

Esempio di impiego



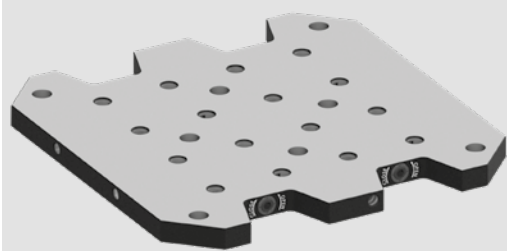

- Completo di:
 - chiave 10mm
 - n. 6 piastrine di sicurezza (cod. 46248215)
- Perni non inclusi

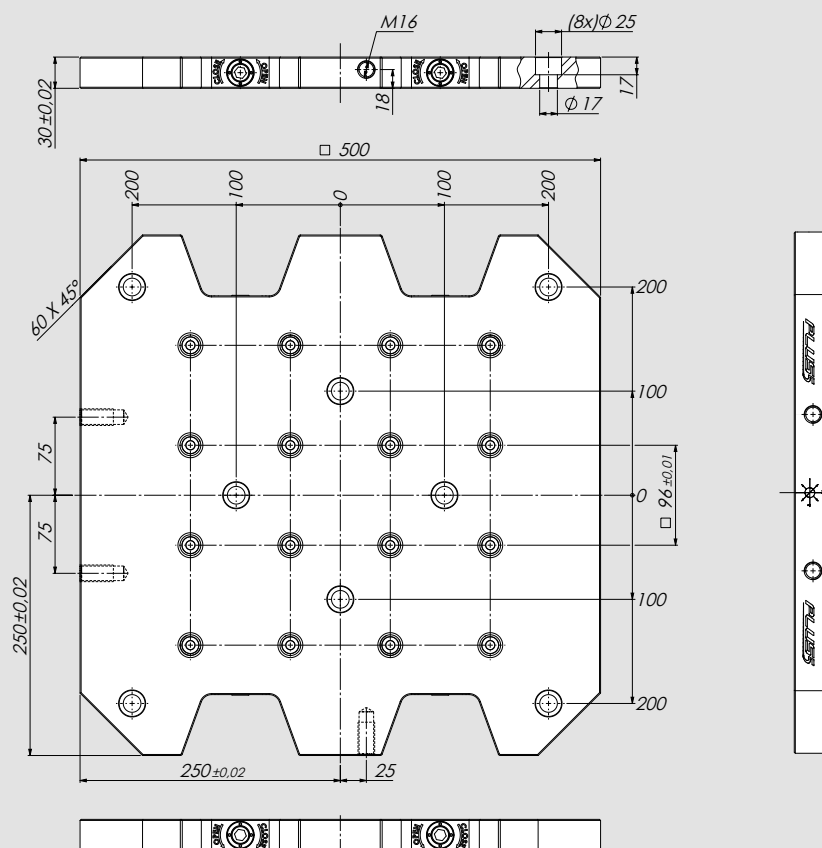

Cod.

46248232

Peso (Kg)

50

Esempio di impiego

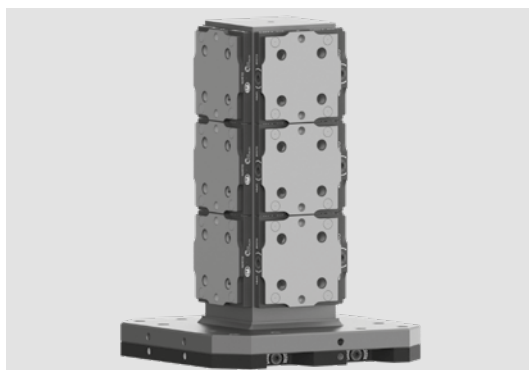



- Completo di:
- chiave 10mm
- n. 4 perni 96 (46240220)

SEZIONE A-A

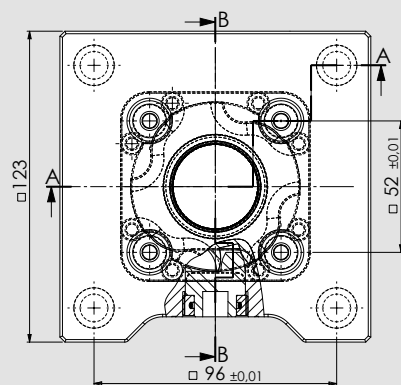
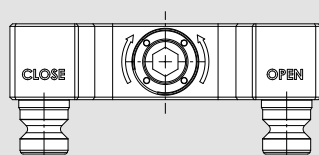
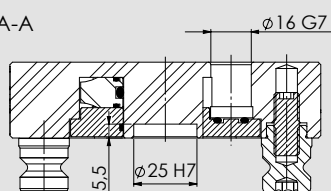

SEZIONE B-B

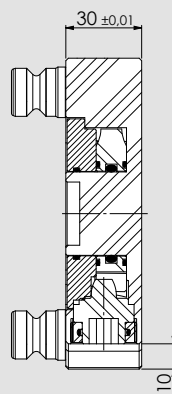

Cod.	Peso (Kg)
46240104	3,5

Esempio di impiego

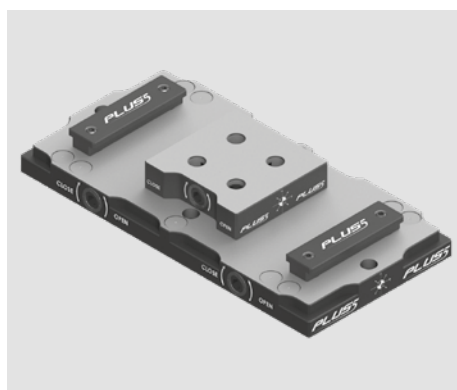
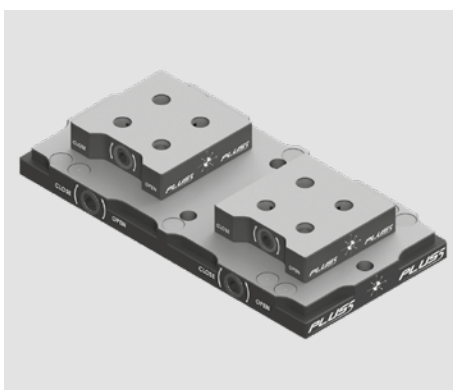

Piastra di riduzione

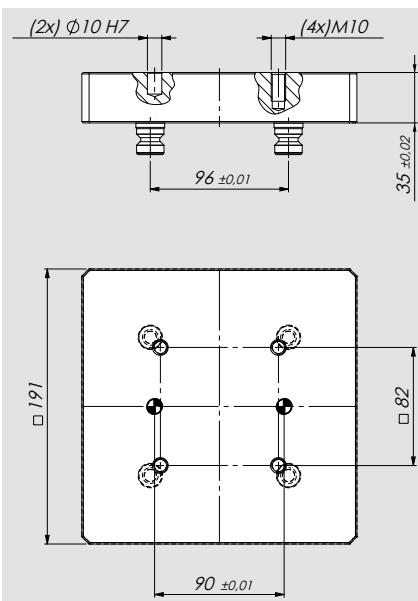
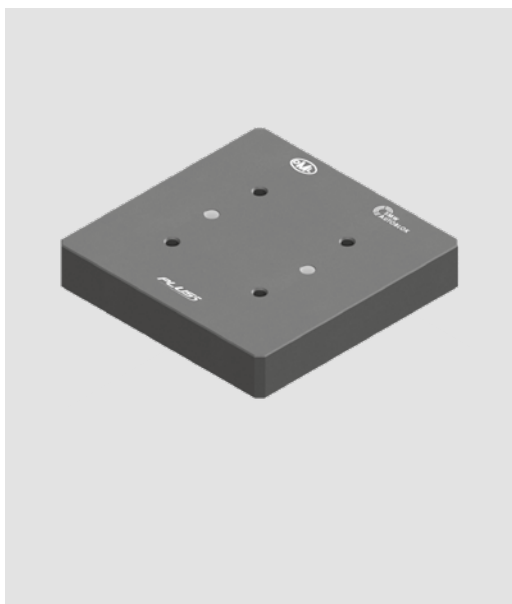

Esempio di impiego



Completo di

- Viti e spine di fissaggio per Plus 5 52
- Set 4 Perni Plus 5 96

Cod.	Peso (Kg)
46242210	10

Piastra di riduzione multipla

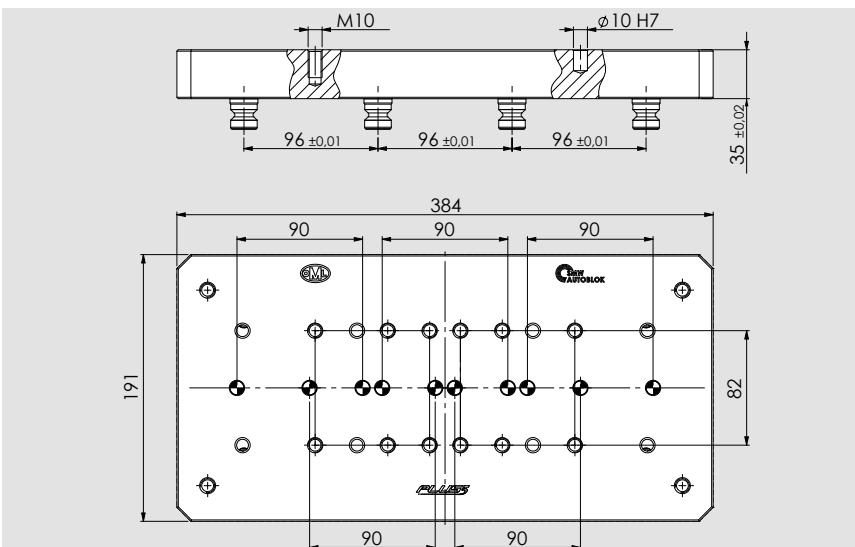

Completo di

- Viti e spine di fissaggio per Plus 5 52
- n. 2 Set 4 Perni Plus 5 96

Cod.	Peso (Kg)
46242220	21

Esempio di impiego



Perni di bloccaggio



- Completì di grano M8 per Plus5 52 e M10 per Plus5 96

52

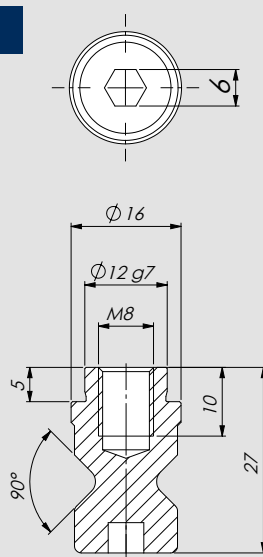

96

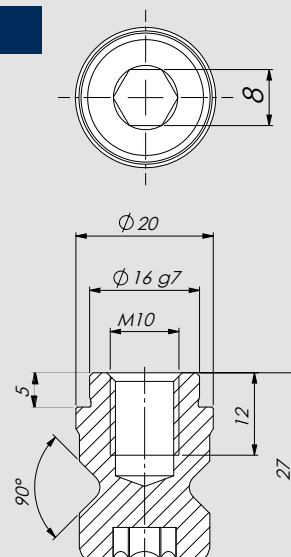

Descrizione	Cod.	Peso (Kg)
Set 4 perni per PLUS 5 - 52	46240214	0,12
Set 4 perni per PLUS 5 - 96	46240224	0,20
Perno per PLUS 5 - 52	46240210	0,03
Perno per PLUS 5 - 96	46240220	0,05

Le dimensioni del perno identificano la compatibilità con altri perni presenti sul mercato

Perni di bloccaggio rialzati

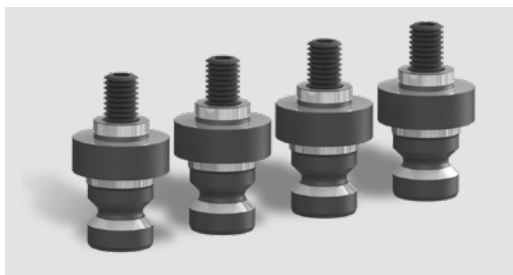

- Completì di grano M8 per Plus5 52 e M10 per Plus5 96

52

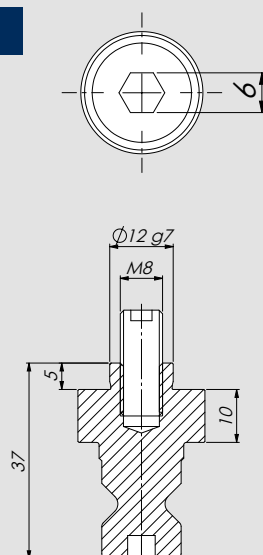

96

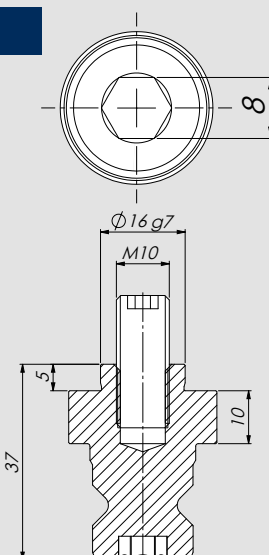

Descrizione	Cod.	Peso (Kg)
Set 4 perni rialzati per PLUS 5 - 52	46240234	0,12
Set 4 perni rialzati per PLUS 5 - 96	46240244	0,20
Perno rialzato per PLUS 5 - 52	46240230	0,03
Perno rialzato per PLUS 5 - 96	46240240	0,05

Le dimensioni del perno identificano la compatibilità con altri perni presenti sul mercato

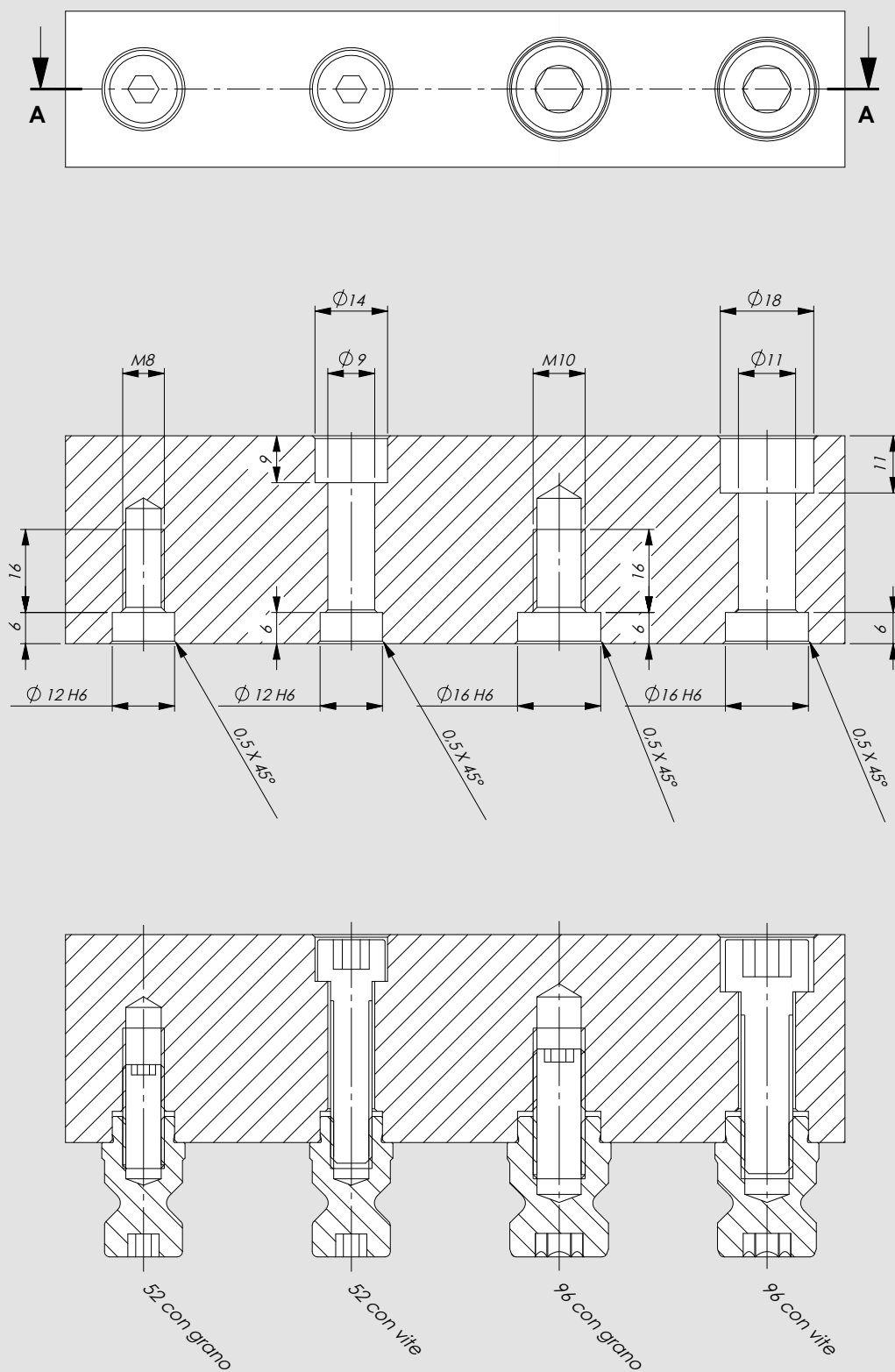

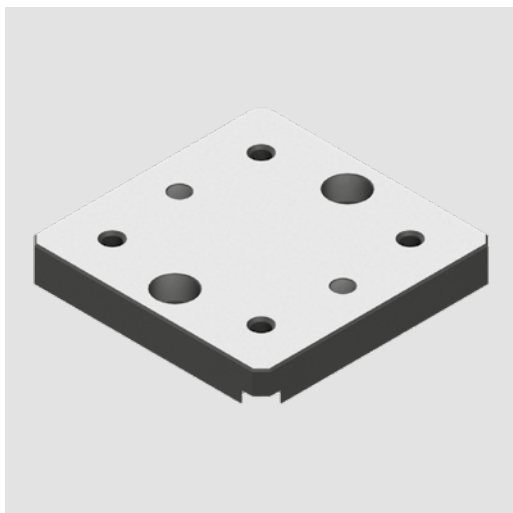

Esempio di impiego

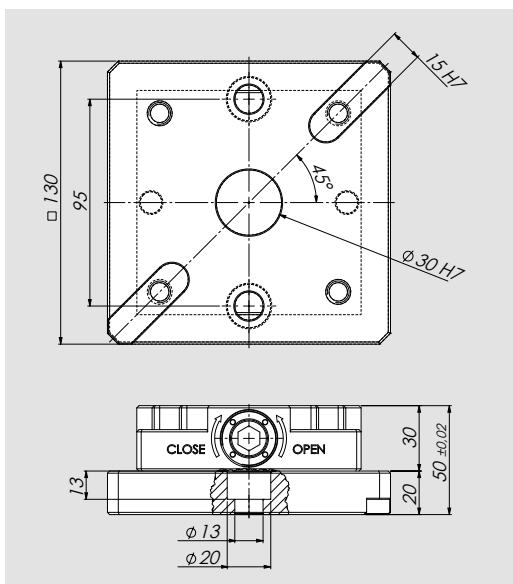

PLUS 5 - 52 Piatra di interfaccia pallets

Completo di viti e spine di fissaggio
Plus 5 non incluso

Cod.	Peso (Kg)
46242110	2,5

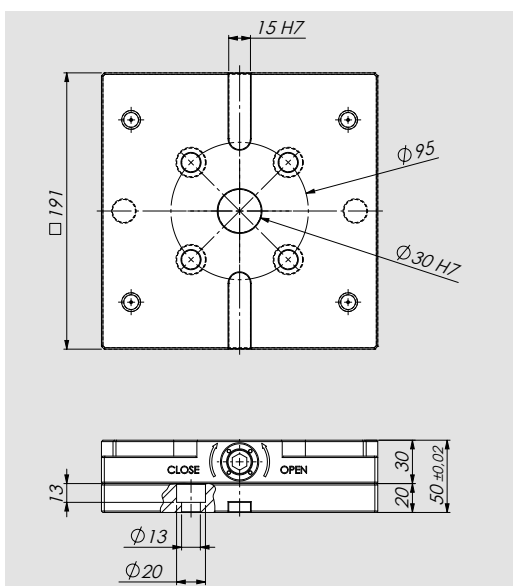

PLUS 5 - 96 Piatra di interfaccia pallets

Completo di viti e spine di fissaggio
Plus 5 non incluso

Cod.	Peso (Kg)
46242120	5,5

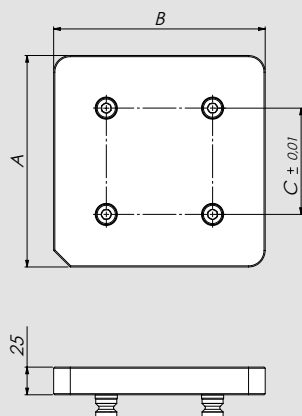

PLUS 5 - 52 / 96 Piastra liscia

Completo di set 4 perni

Cod.	Tipo	A	B	C	Peso
46247710	52	103	103	52	2 Kg
46247720	96	191	191	96	7 Kg

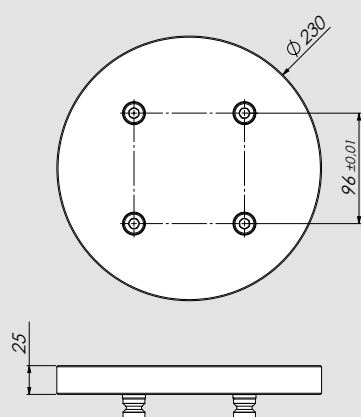

PLUS 5 - 96 Piastra liscia tonda

Completo di set 4 perni

Cod.	Peso (Kg)
46247730	8

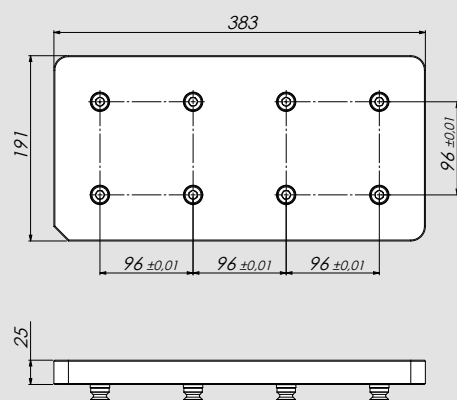

PLUS 5 - 96 Piastra liscia doppia

Completo di n. 2 set 4 perni Plus 5 96

Cod.	Peso (Kg)
46247740	15

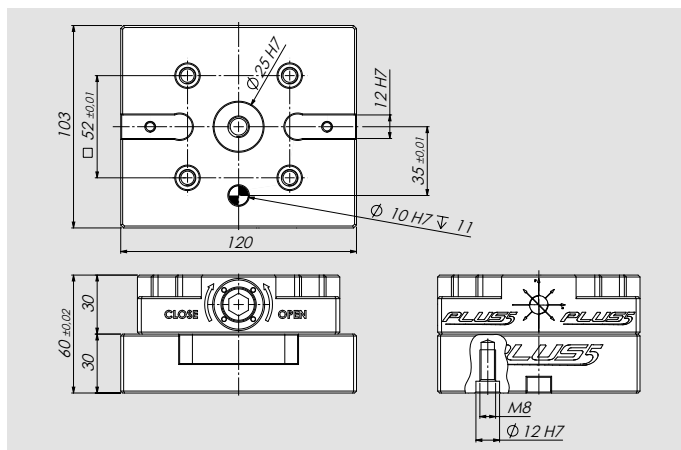

RIALZO PLUS 5 - 52 (H tot = 60)

Completo di viti e spine di fissaggio
Plus 5 non incluso

Cod.	Peso (Kg)
46242018	2

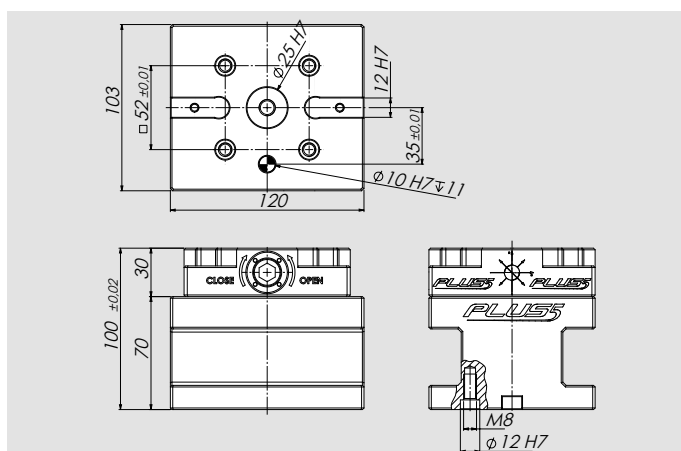

RIALZO PLUS 5 - 52 (H tot = 100)

Completo di viti e spine di fissaggio
Plus 5 non incluso

Cod.	Peso (Kg)
46242019	5

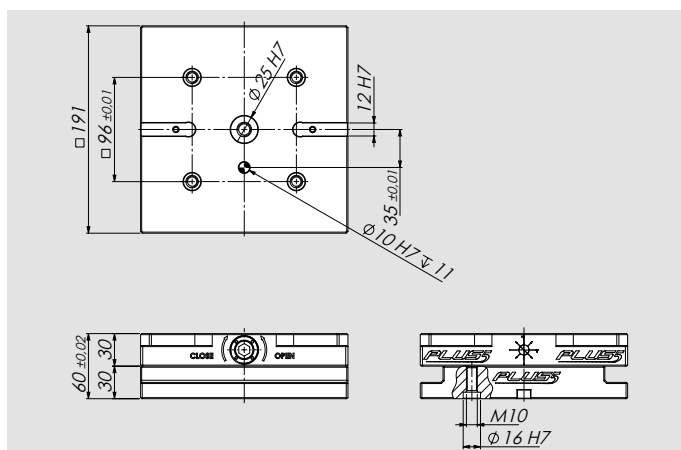

RIALZO PLUS 5 - 96 (H tot = 60)

Completo di viti e spine di fissaggio
Plus 5 non incluso

Cod.	Peso (Kg)
46242028	7

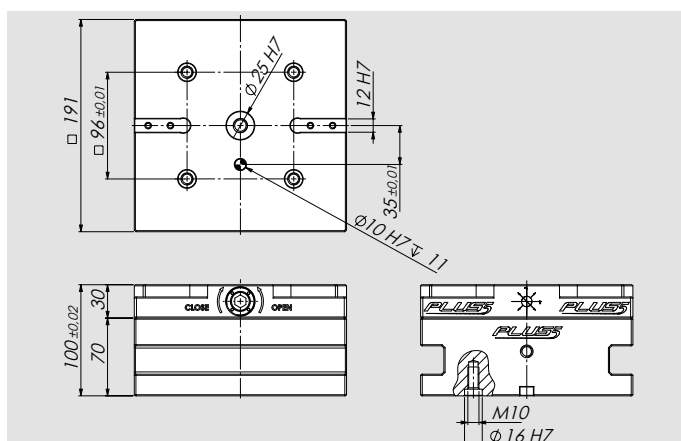

RIALZO PLUS 5 - 52-96 (H tot = 100)

Completo di viti e spine di fissaggio
Plus 5 non incluso

Cod.	Peso (Kg)
46242029	18

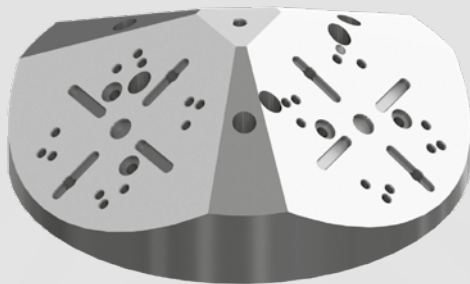

Applicazioni/Benefici cliente

- Ideale per macchine a 5 assi
- Design compatto
- Possibilità di montaggio diretto su tavola macchina con cave radiali a 45 / 60 gradi
- Possibilità di montaggio diretto su sistemi Zero Point APS e Plus5

Caratteristiche tecniche

- Materiale: ALU

Dotazione standard

Chiavette e viti per morse IMG, V5 e E5
Perni e viti per Plus 5

IMG 88 - 130
V5 88 - 130
E5 88 - 130
PLUS 5 - 52

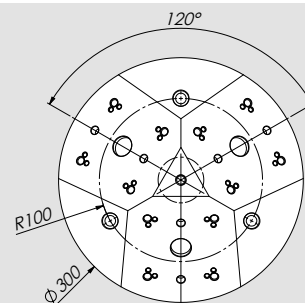
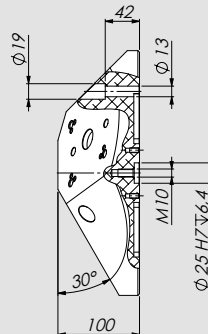
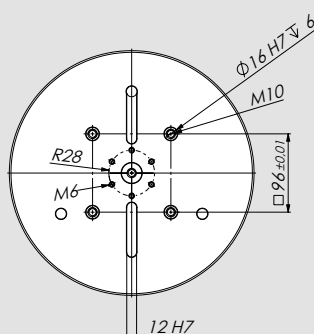

IMG 125 - 180
IMG 125 - 220
V5 125 - 180
E5 125 - 180
PLUS 5 - 96

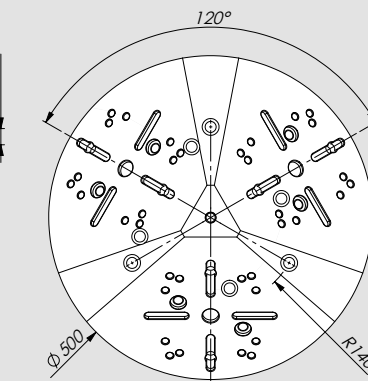
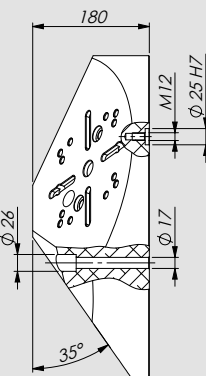
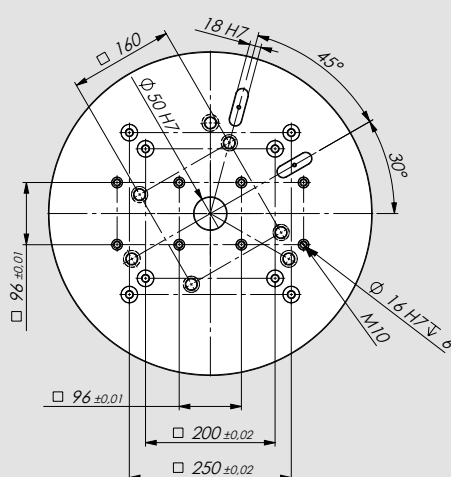

Tipo	Cod.	Peso (Kg)
Per IMG, V5, E5 88-130 e PLUS 5 - 52	58343210	12
Per IMG 125-180, IMG 125-220, V5, E5 125-180 e PLUS 5 - 96	58353210	55

Esempio di impiego

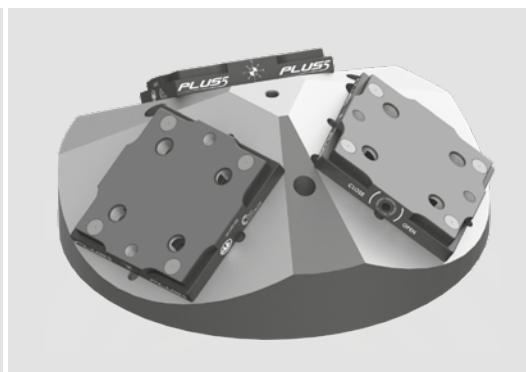
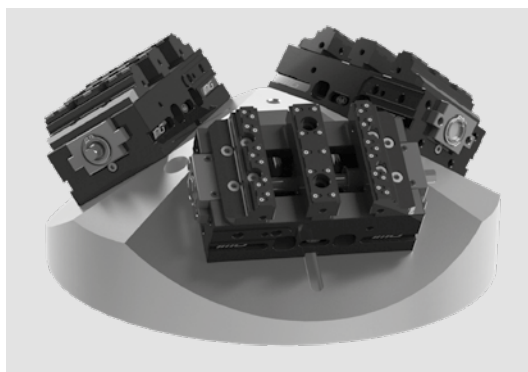



Plus 5 - 52 non incluso

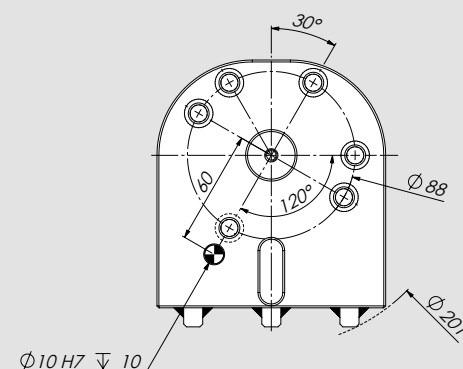
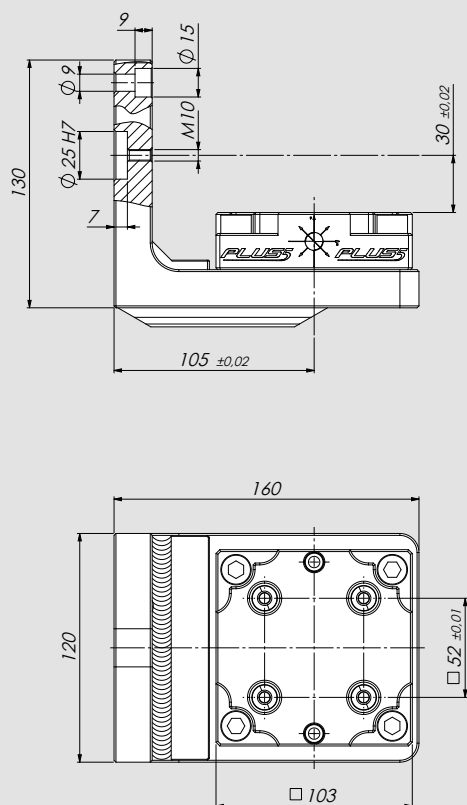

Cod.

46242038

Peso

6

Esempio di impiego

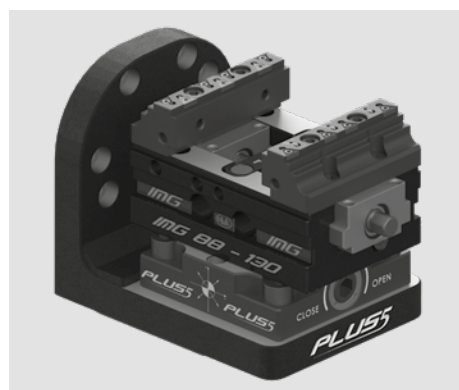
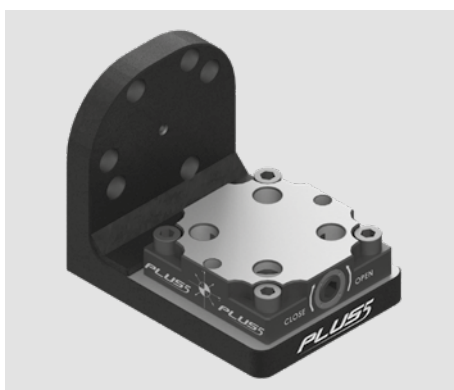



Plus 5 - 96 non incluso

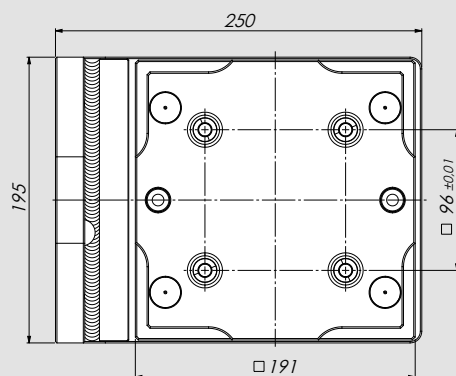
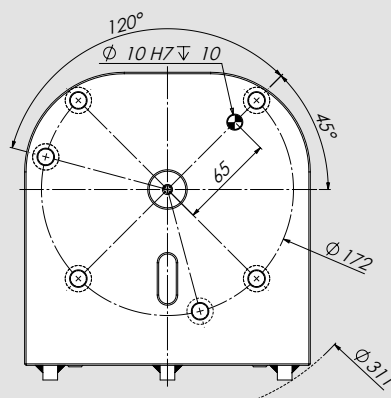
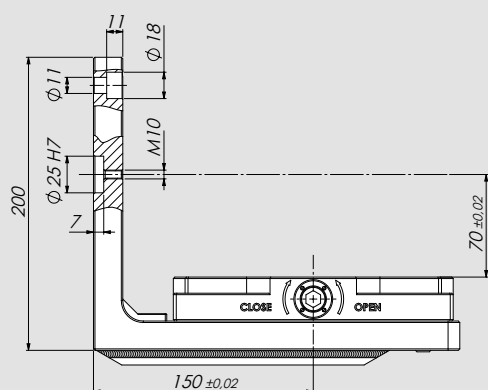

Cod.	Peso
46242039	14

Esempio di impiego

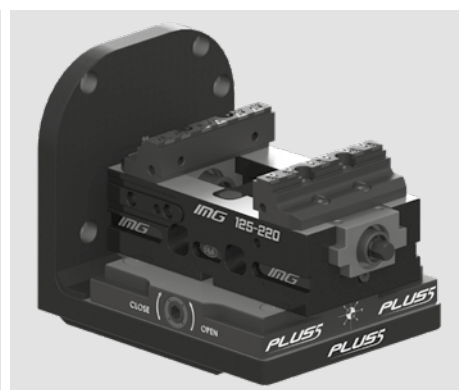
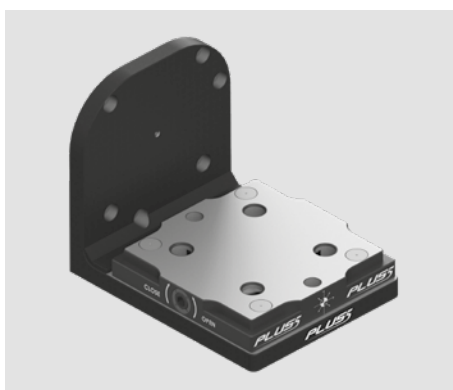



- Completo di:
 - chiave 10mm
 - n. 2 piastrine di sicurezza (cod. 46248215)
- Perni non inclusi

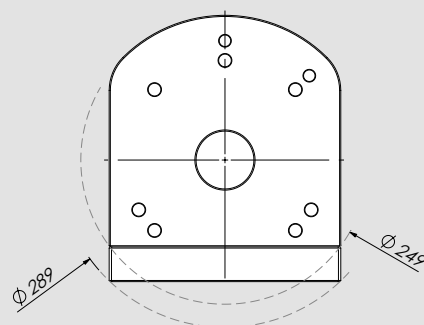
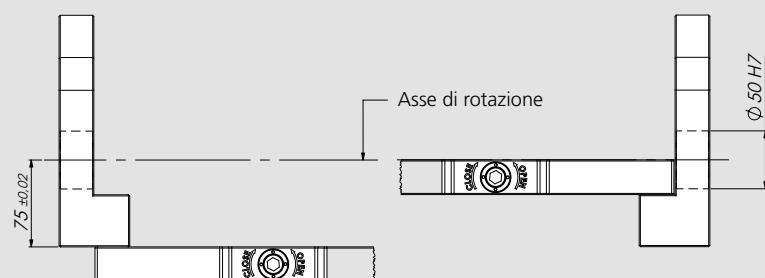
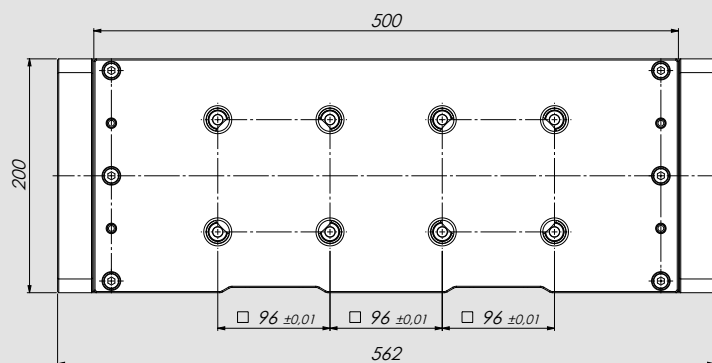
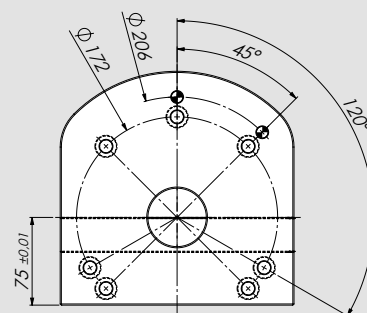
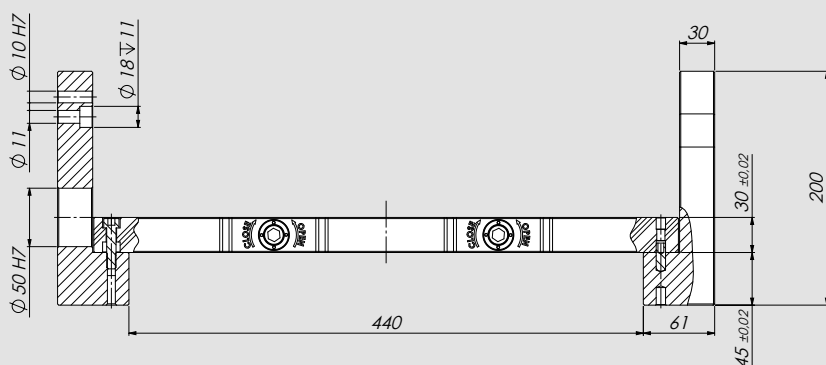

Cod.

46248320

Peso

43

PLUS 5 - 96

Piastrina di sicurezza per bloccaggio su due moduli diversi. Completo di perni 96

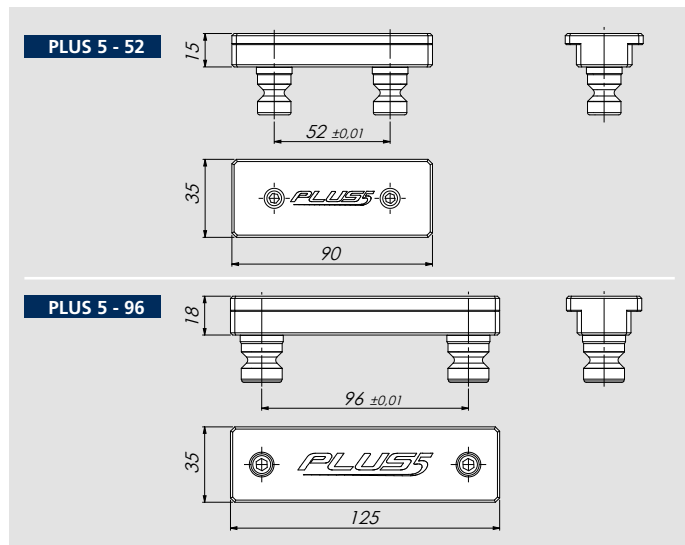

Modello	Codice	Peso
Plus 5 - 52	46248205	0,3
Plus 5 - 96	46248215	0,4

PLUS 5 - 52

Piastra allineamento completa di perni 52

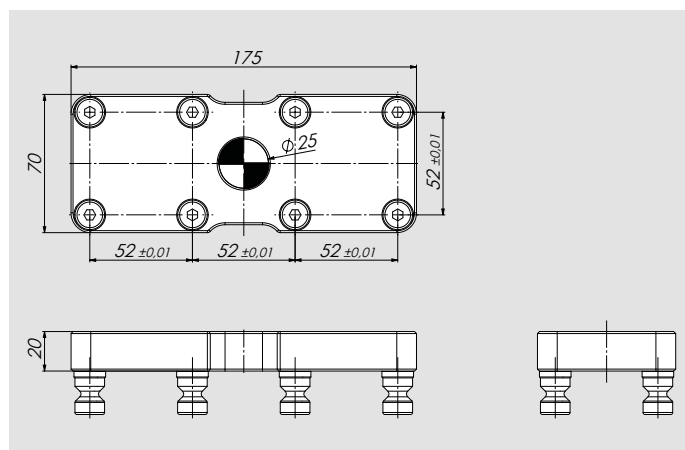

Cod.	Peso (Kg)
46240410	2

PLUS 5 - 96

Piastra allineamento completa di perni 96

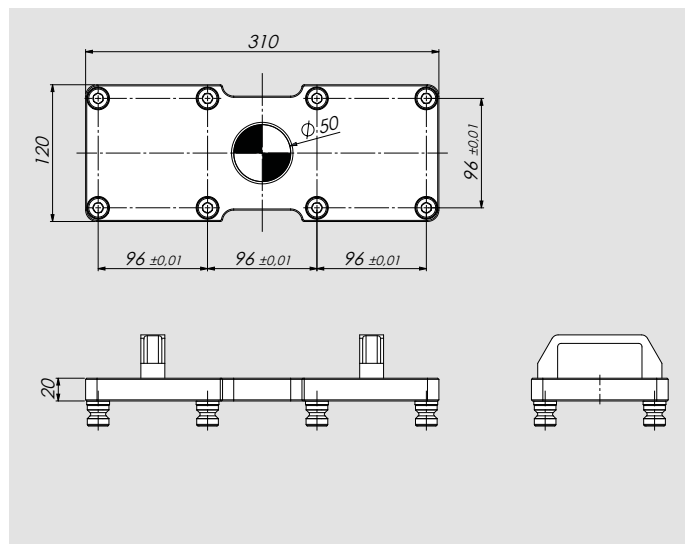

Cod.	Peso (Kg)
46240420	6

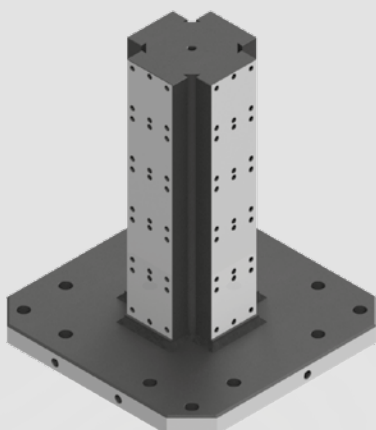

Applicazioni/Benefici cliente

- Ideale per macchine orizzontali
- Design compatto

Caratteristiche tecniche

- Materiale: acciaio

Dotazione standard

Cubo in acciaio completo di viti e spine di fissaggio

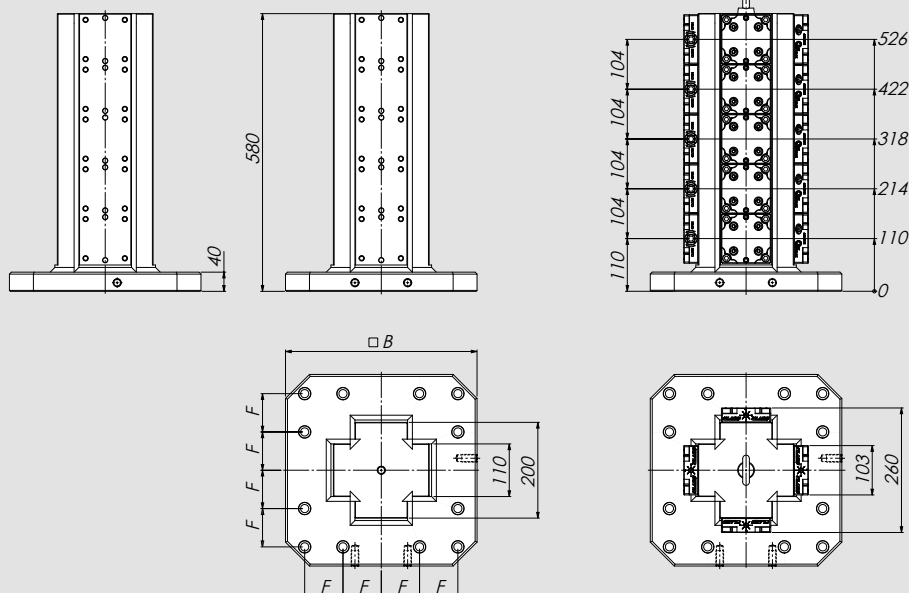

Tipo	Cod.	B	F	Peso	Peso (solo cubo)
Cubo Plus 5 - 52 - Base 400	46247110	400	80	162 Kg	121 Kg
Cubo Plus 5 - 52 - Base 500	46247120	500	100	190 Kg	148 Kg

Esempio di impiego



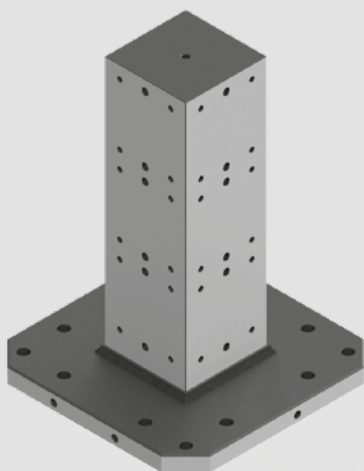

Applicazioni/Benefici cliente

- Ideale per macchine orizzontali
- Design compatto

Caratteristiche tecniche

- Materiale: acciaio

Dotazione standard

Cubo in acciaio completo di viti e spine di fissaggio

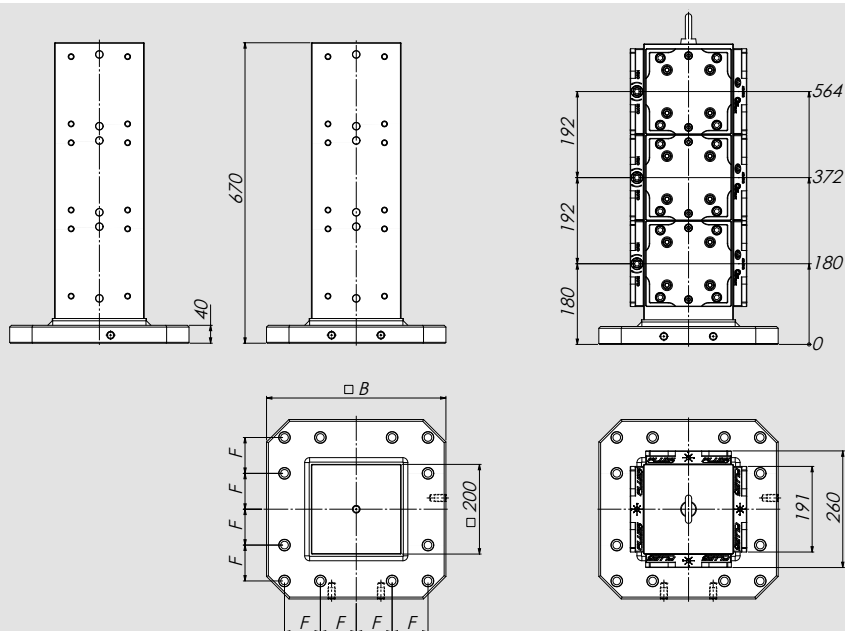

Tipo	Cod.	B	F	Peso	Peso (solo cubo)
Cubo Plus 5 - 96 - Base 400	46247210	400	80	253 Kg	160 Kg
Cubo Plus 5 - 96 - Base 500	46247220	500	100	280 Kg	187 Kg

Esempio di impiego

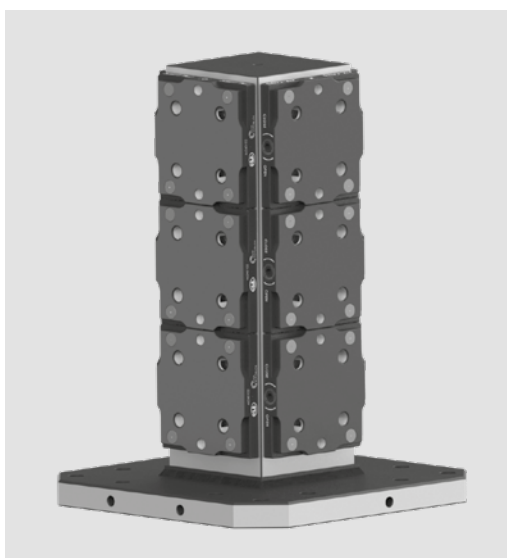

PLUS 5 - 52/96

Coppia Staffe Fissaggio

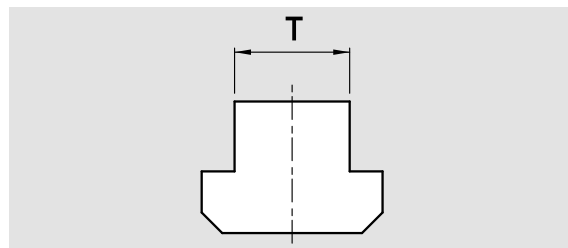
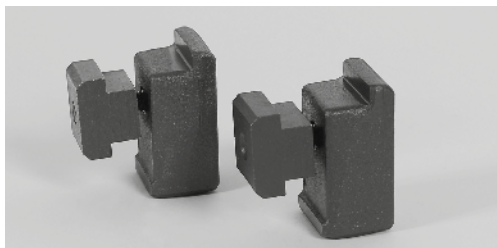

Tipo	mm 12	mm 14	mm 16	mm 18	mm 20	mm 22
PLUS 5 52/96	58022792	58022793	58022794	58022795	58022796	58022797

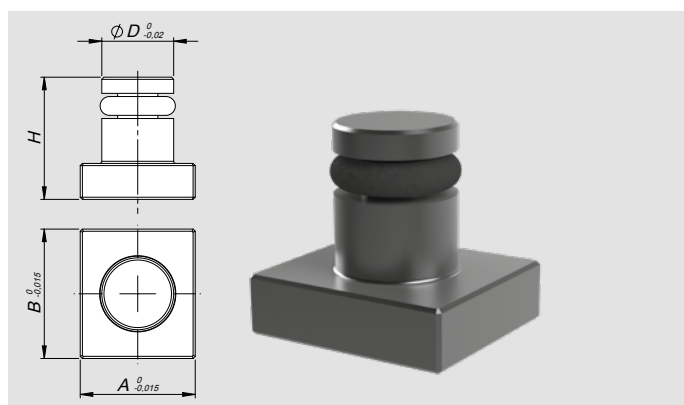

Chiavetta solo per

- Plus 5 52
- Plus 5 Index 96

Cod.	A	B	H	D
58341393	12	14	17	10
58341395	16	18	17	10

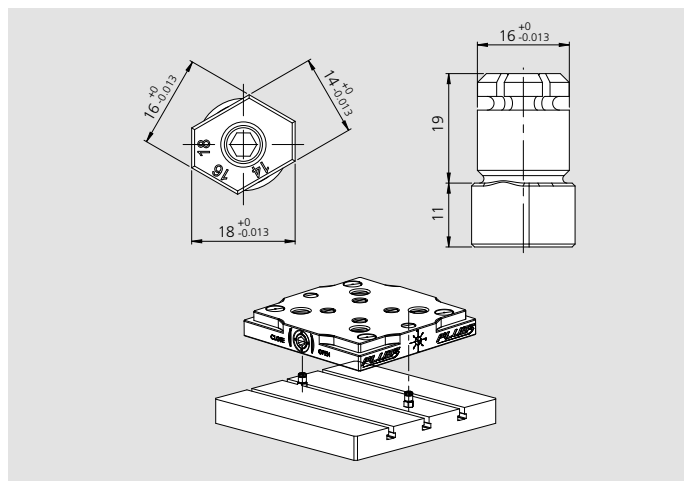

Chiavetta multi-slot per Plus 5 96

Tipo	Cod.
Multi-Slot 14 / 16 / 18	71290182



PLUS 5 - 52/96

Tappo di protezione in acciaio

Tipo	Cod.	Peso (Kg)
Set 4 tappi Plus 5 52	46240314	0,08
Set 4 tappi Plus 5 96	46240324	0,16
Tappo di protezione Plus 5 52	46240310	0,02
Tappo di protezione Plus 5 96	46240320	0,04

MANDRINO PORTA PINZA ER50

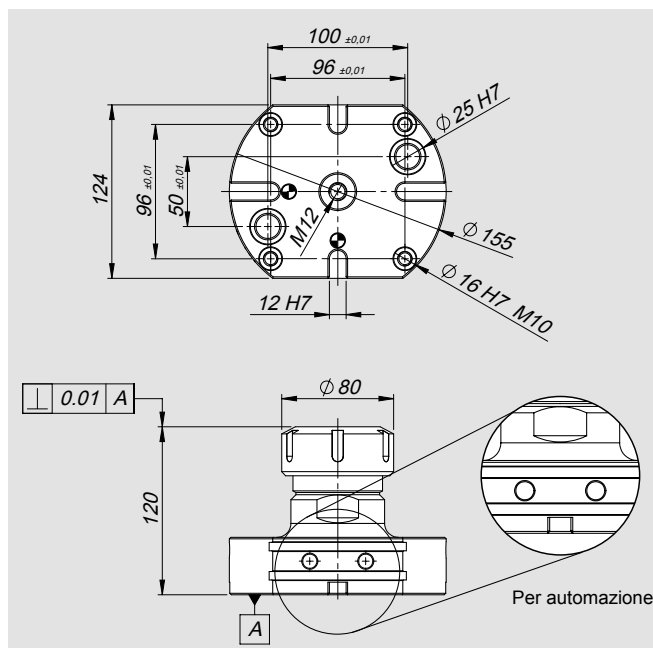

Cod.

46233500

Esempio di impiego



